

2022 Asset Management Plan

Core Assets

City Council

July 25, 2022



1. Provincial Requirements
2. Asset Management Overview
3. 2022 Asset Management Plan Scope & Elements
4. State of Local Infrastructure
5. Levels of Service
6. Asset Management Strategy
7. Financial Strategy
8. Next Steps

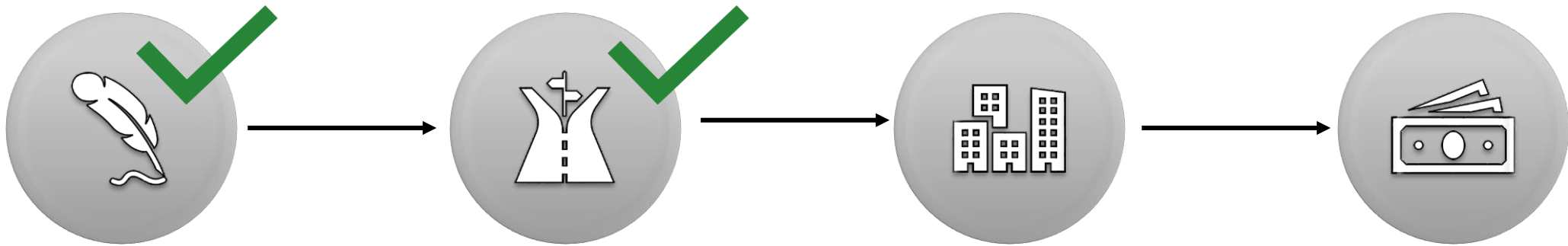

**STRATEGIC ASSET
MANAGEMENT POLICY**

July 2019

**ASSET MANAGEMENT
PLAN – CORE ASSETS**

July 2022

**ASSET MANAGEMENT
PLAN – ALL ASSETS**

July 2024

**PROPOSED LEVELS OF
SERVICE AND
FINANCIAL STRATEGY**

July 2025

Asset management is the **coordinated activity** in place to manage the way in which the City **realizes value** from its **assets** in order to **provide services** effectively and in a **financially sustainable** manner.



The goal of an asset management program is to build, maintain and operate infrastructure cost-effectively, provide value to the customer, and improve the credibility and accountability of the municipality.

An asset management plan (AMP) is a **strategic document** that states how a group of assets is to be managed over a period of time.

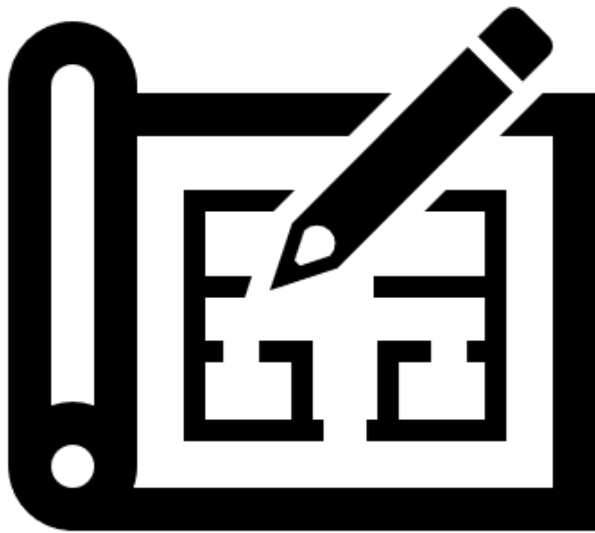

The plan describes the characteristics and condition of infrastructure assets, the level of service expected from them, planned actions to ensure the assets are providing the expected level of service, and financing strategies to implement the planned actions.



ROAD NETWORK

Roads, sidewalks, curbs, guiderails



BRIDGE NETWORK

Bridges (vehicular & pedestrian), culverts



STORMWATER NETWORK

Collection pipes, manholes, catch basins, ditch inlets, leads, stormceptors, retention ponds, drainage channels, stormwater services

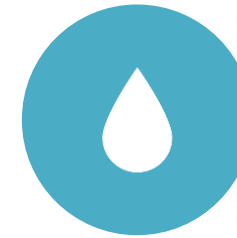

WATER NETWORK

Watermains, valves, water chambers, fire hydrants, water services, pumping stations, water treatment plant



WASTEWATER NETWORK

Collection pipes, manholes, force mains, wastewater services, wastewater treatment plant

Asset Summary

- Inventory, replacement costs, average age, condition

Levels of Service

- Current

Asset Management Strategy

- Lifecycle activities, funding vs. need

Financial Strategy

Improvement Plan

STATE OF LOCAL INFRASTRUCTURE



What do we have?



What condition is it in?



How old is it?

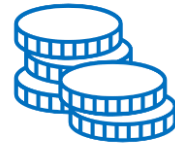

What is it worth?

Assets Included in the Plan - \$1,189,542,907

Bridges - \$27,697,414

Roads - \$156,238,101

**Stormwater –
\$188,901,888**

**Wastewater
\$394,643,371**

**Water Network -
\$422,062,133**

STATE OF LOCAL INFRASTRUCTURE

Asset Category	Replacement Value (2022 \$)	Average Annual Requirement	Average Annual Deficit	Overall Rating
Road Network	\$ 156,238,101	\$9,675,315	\$ 390,129	B +
Bridge and Culvert Network	\$ 27,697,414	\$185,906	\$ 126,951	C -
Stormwater Network	\$ 188,901,888	\$3,284,057	\$ 2,519,184	D +
Water Network	\$ 422,062,133	\$19,209,466	\$ 11,407,780	D -
Wastewater Network	\$ 394,643,371	\$13,296,354	\$ 7,902,857	D +
Total Core Assets	\$ 1,189,542,907	\$45,651,099	\$ 22,346,901	C -

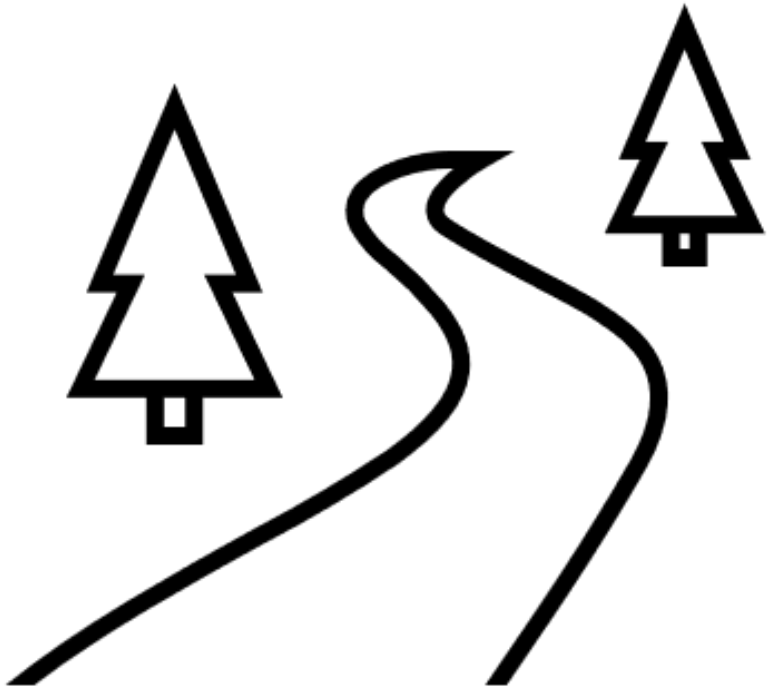

- **Replacement value:** \$156.2 M
- **Average annual requirement:** \$9.7 M
- **Average annual funding:** \$9.3 M
- **Average annual deficit:** \$390,000
- **Funding vs. Need ratio:** 96%

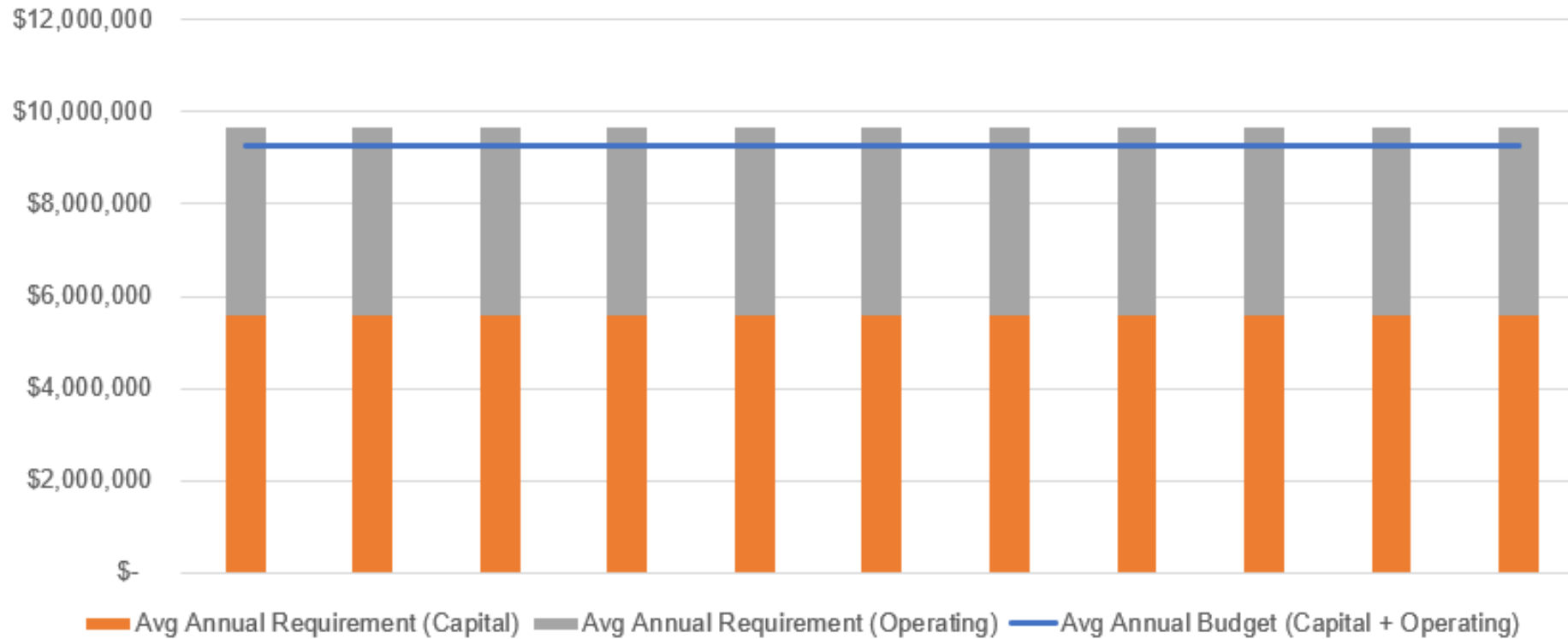



- **Replacement value: \$27.7 M**
- **Average annual requirement: \$186,000**
- **Average annual funding: \$59,000**
- **Average annual deficit: \$127,000**
- **Funding vs. Need ratio: 32%**

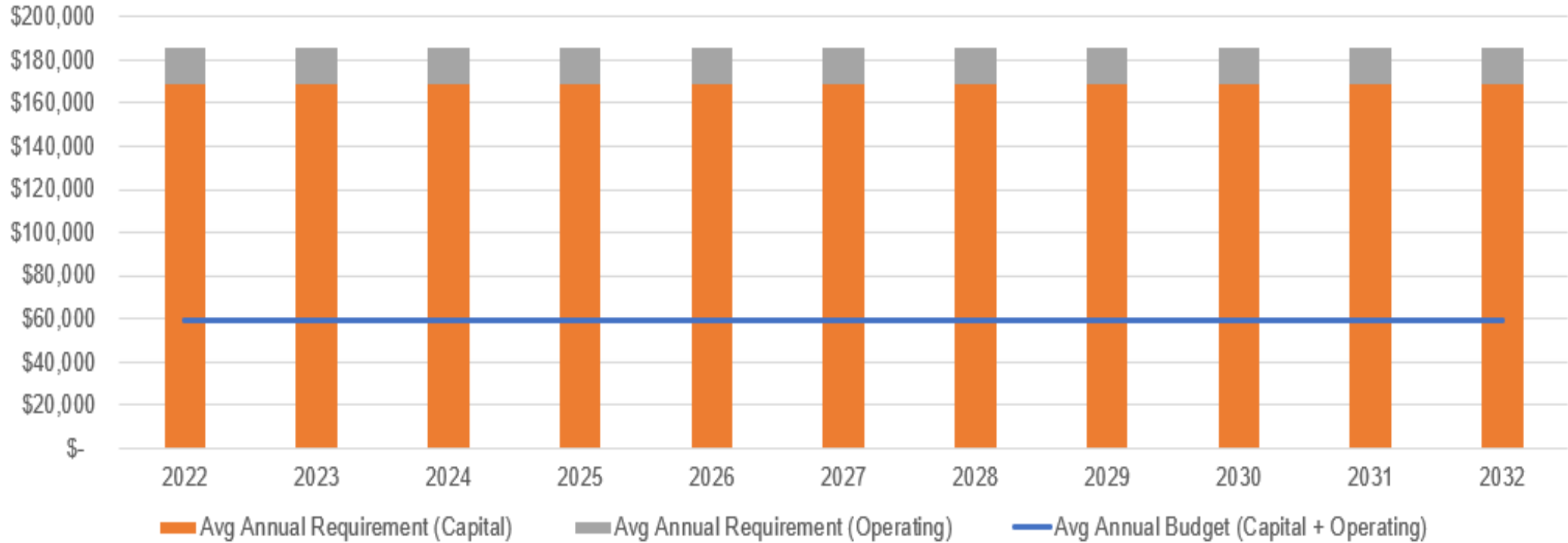



- **Replacement value: \$188.9 M**
- **Average annual requirement: \$3.3 M**
- **Average annual funding: \$765,000**
- **Average annual deficit: \$2.5 M**
- **Funding vs. Need ratio: 23%**

STORMWATER NETWORK

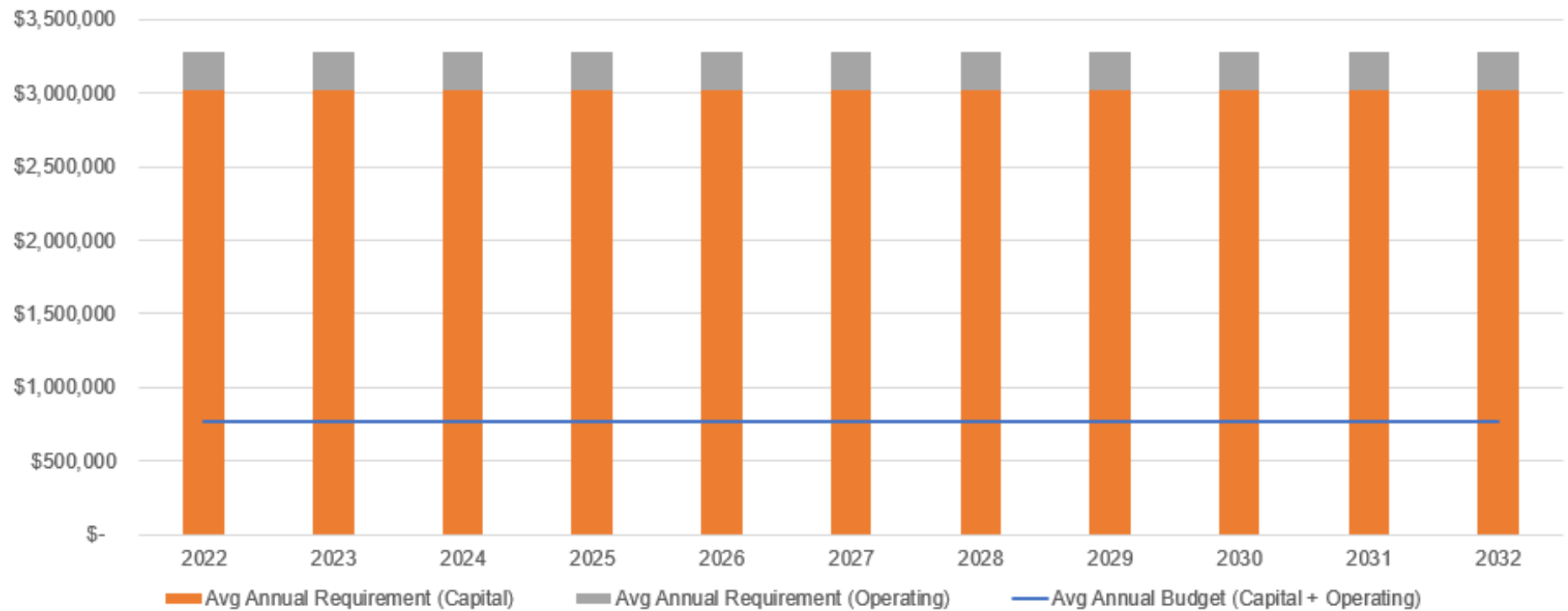

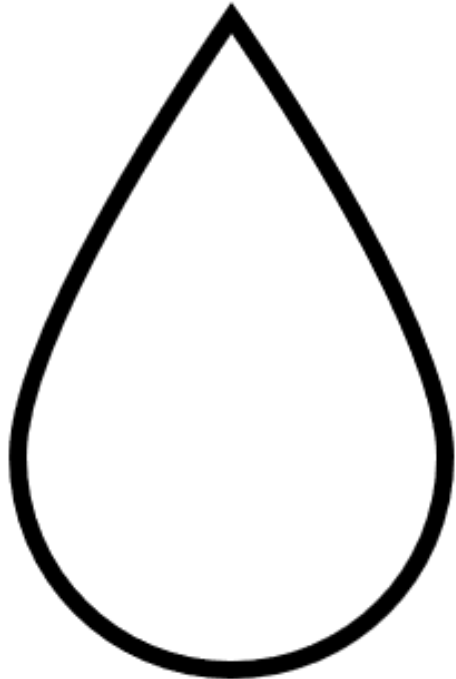

- **Replacement value: \$422.1 M**
- **Average annual requirement: \$19.2 M**
- **Average annual funding: \$7.8 M**
- **Average annual deficit: \$11.4 M**
- **Funding vs. Need ratio: 40%**

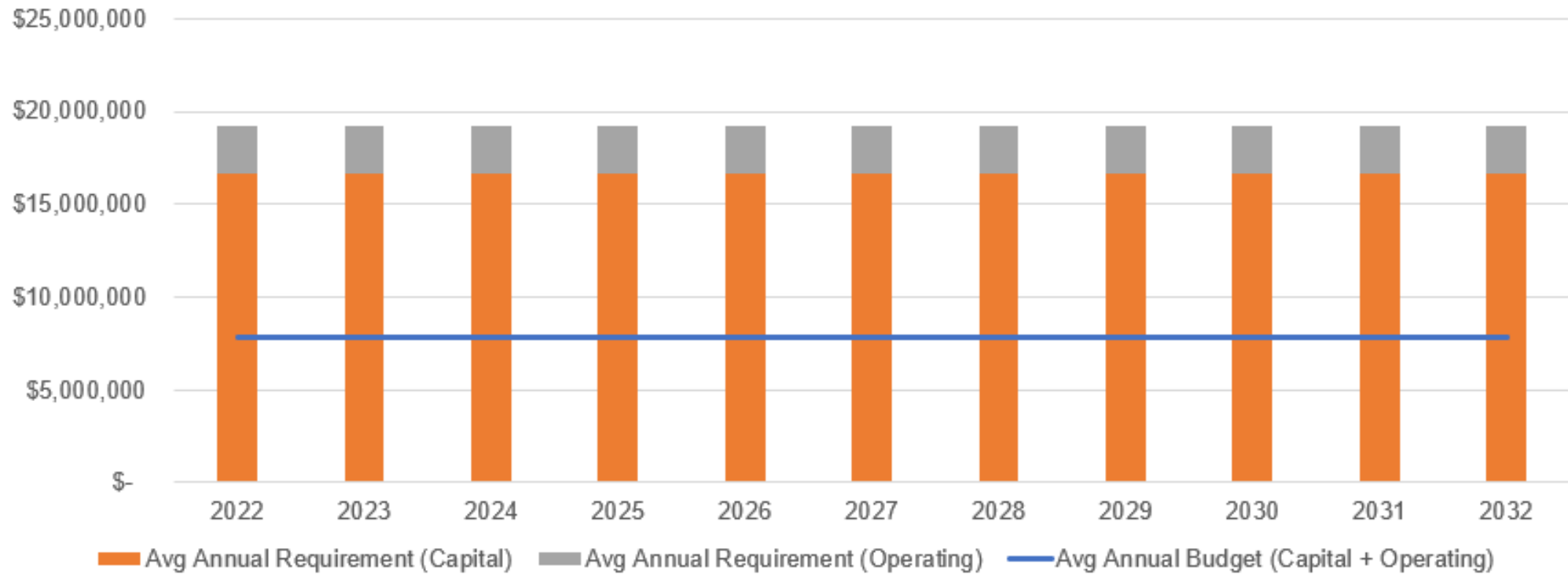

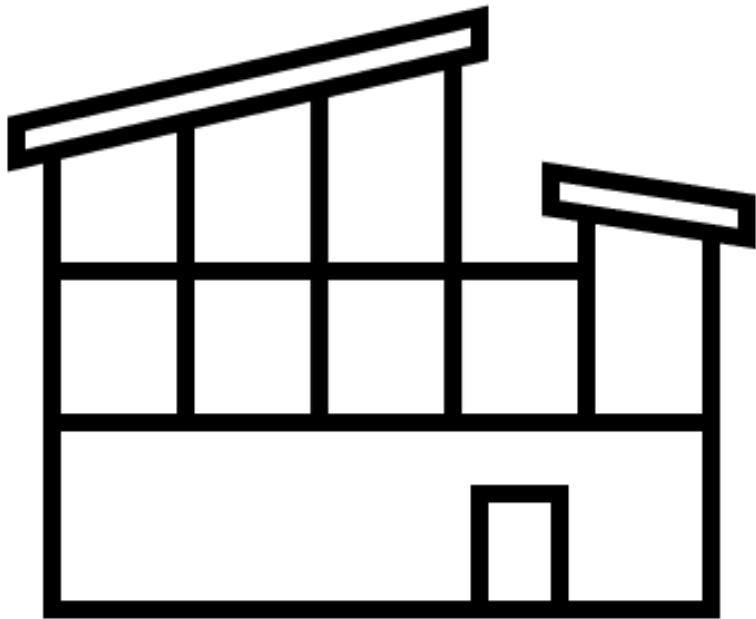

- **Replacement value: \$394.6 M**
- **Average annual requirement: \$13.3 M**
- **Average annual funding: \$5.4 M**
- **Average annual deficit: \$7.9 M**
- **Funding vs. Need ratio: 40%**

WASTEWATER NETWORK

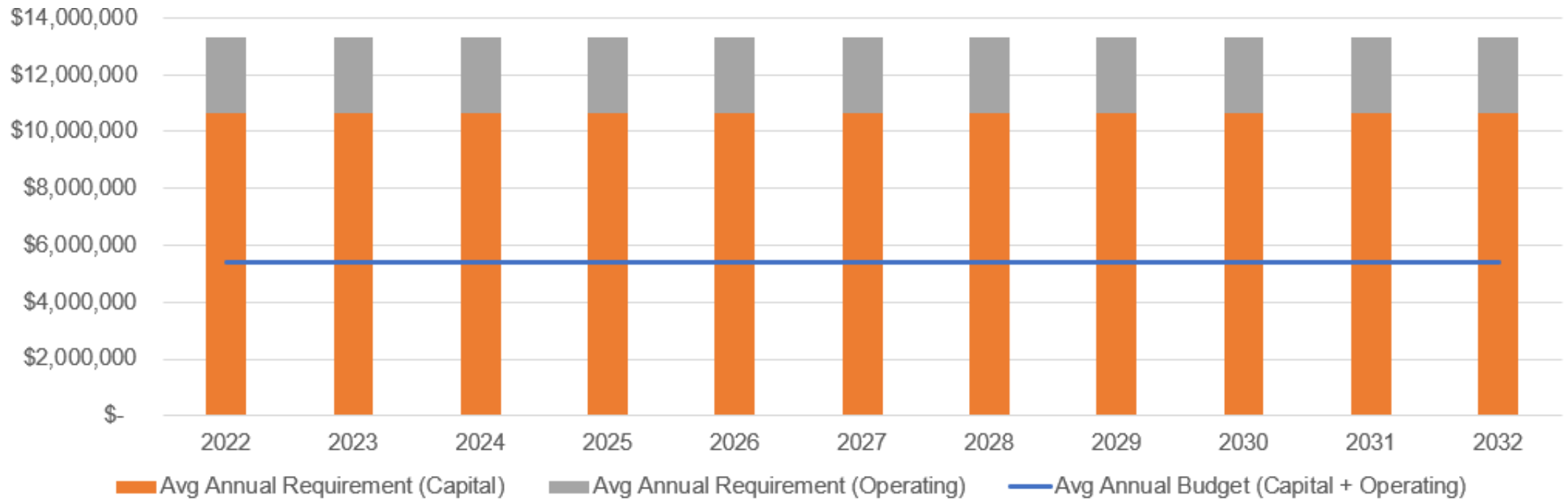

Asset Category	Condition vs. Performance	Funding vs. Need	Overall Rating
Road Network	B -	A	B +
Bridge and Culvert Network	A -	F	C -
Stormwater Network	B	F	D +
Water Network	C -	F	D -
Wastewater Network	B -	F	D +
Total Core Assets	B -	D	C -

Levels of service describe **what people** (residents, users of assets, etc.) **experience** from a municipality's infrastructure.

Levels of service can be **qualitative** in nature and describe what is **important to users/how they feel** about the services, or they can be **quantitative** in nature (based on data and **metrics**).

Strategic Level

- Highest level indicators
- Set and reviewed by highest level of decision makers (Council)
- Budgeting and investment
- **Example:** increase annual investment in maintenance by 10% over next 2 years

Tactical Level

- Set and reviewed by managerial level decision makers
- Condition indices
- **Example:** increase overall condition vs. performance level to 80% in next 5 years

Operational Level

- Data is collected by staff in field
- Statistical data
- **Example:** Reduce number of customer complaints by 20% or reduce number of watermain breaks to 5 per year

A set of **planned actions** that will enable the asset to provide the agreed-upon **levels of service** in a **sustainable** way, while **managing risk**, at the **lowest lifecycle cost**.

Figure 4: Small but Timely Renewal Investments Save Money

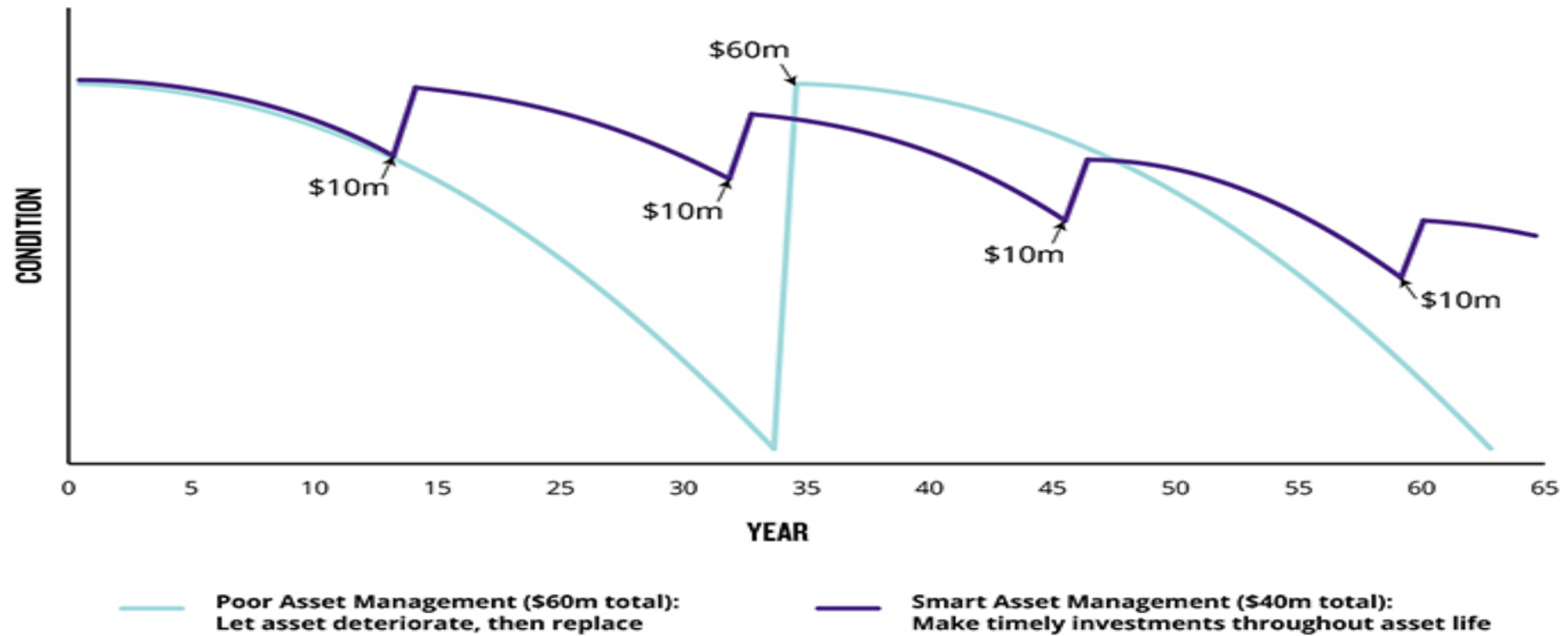

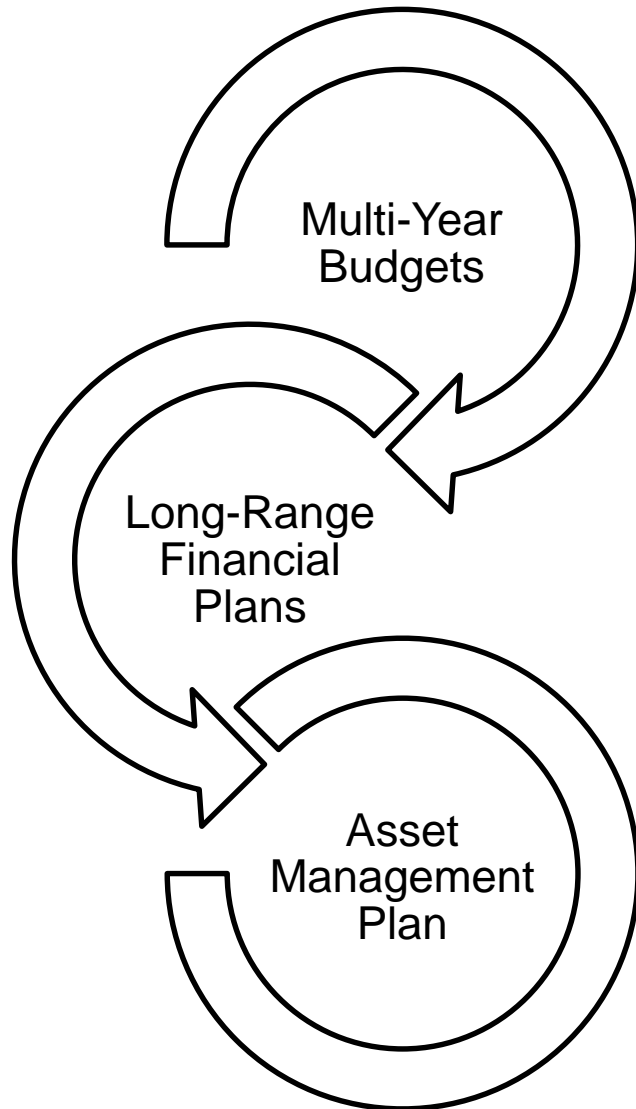

Will be further developed
upon to meet 2025
legislative requirement



