

TITLE BLOCK REV 03- JUNE 2023

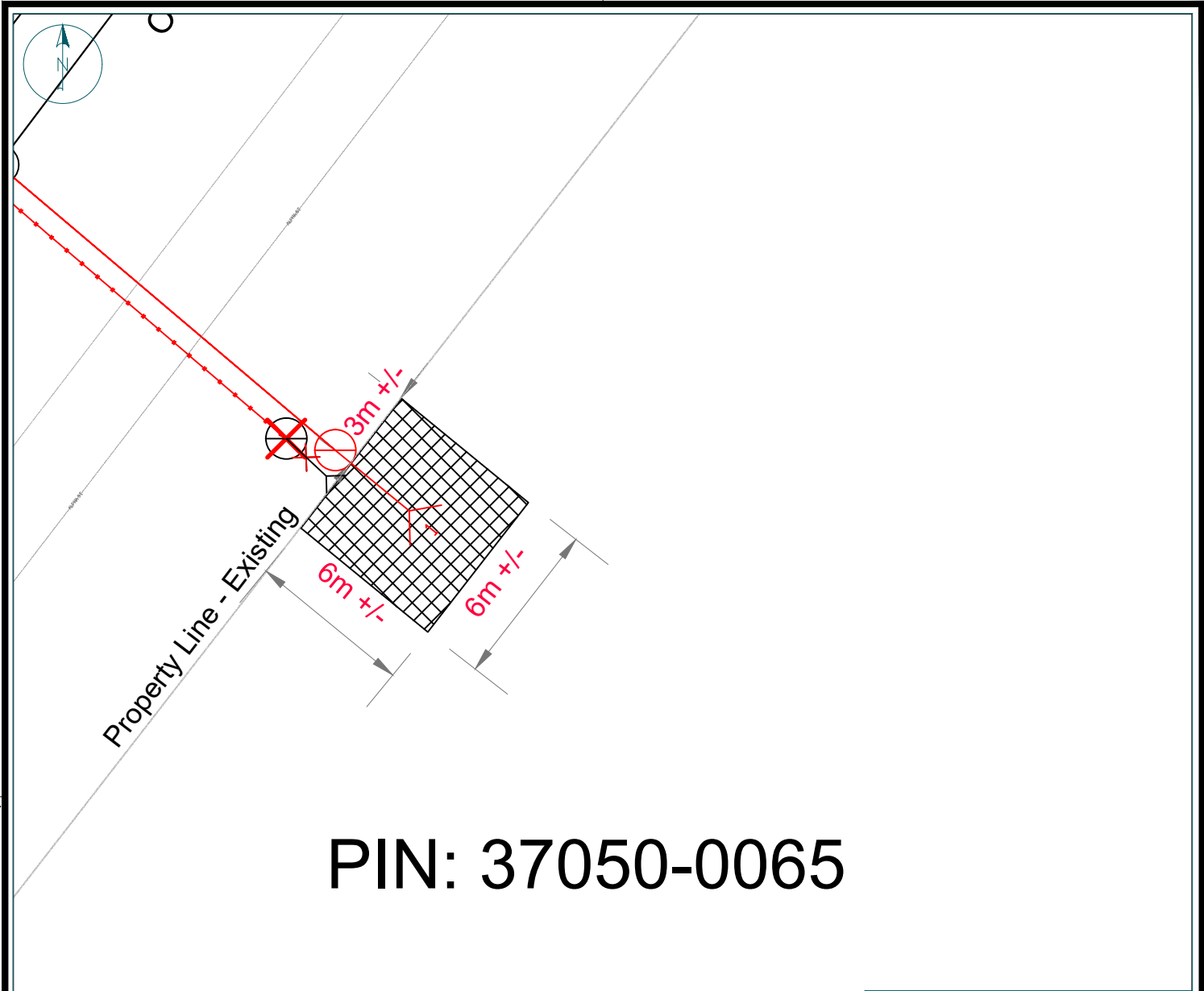

PIN: 37050-0065

All Dimensions are in Meters
Not to Scale

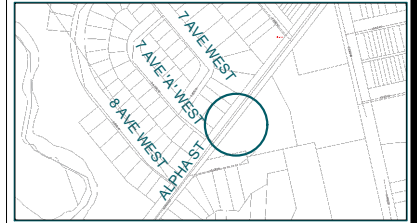

KEY MAP (NTS)

© Copyright Hydro One Networks Inc. All rights reserved. This drawing may not be reproduced or copied, in whole or in part, in any printed, mechanical, electronic, film, or other distribution and storage media or used in any information storage or retrieval system outside of Hydro One Networks Inc., without the written consent of Hydro One Networks Inc. Information contained in this drawing is considered to be confidential. Recipients shall only use the drawing for its intended purpose and shall take necessary measures to prevent disclosure or transmittal to outside parties.



Hydro One Networks Inc.
DESIGN SERVICES
SCHEDULE A

LINETYPES	
--- OVERHEAD - 1PH	--- UNDERGROUND - 1PH
--- OVERHEAD - 2PH	--- UNDERGROUND - 2PH
--- OVERHEAD - 3PH	--- UNDERGROUND - 3PH
--- OVERHEAD - Sec.	--- UNDERGROUND - Sec.
---(PRV) OVERHEAD - Priv. 1PH	---(PRV) UNDERGROUND - Priv. 1PH
---(PRV) OVERHEAD - Priv. 2PH	---(PRV) UNDERGROUND - Priv. 2PH
---(PRV) OVERHEAD - Priv. 3PH	---(PRV) UNDERGROUND - Priv. 3PH
---(SUB) SUBMARINE - 1PH	---(SUB) UNDERGROUND - Priv. Sec.
---(SUB) SUBMARINE - 2PH	
---(SUB) SUBMARINE - 3PH	

COLOR SCHEME	
 Existing	 Hydro One Only
 Hydro One or Contractor	 Work by Others (Bell/LDC)
 Work by Customer	

SYMBOLS	
	PROPOSED POLE - Wood, Composite, Steel, Joint Use/Customer
	EXISTING POLE - Wood, Composite, Steel, Joint Use/Customer
	O/H - U/G TRANSITION (DIP/RISE) - Primary, Secondary
	ANCHORS/DOWN GUY - Hydro, Private/Joint Use, Push Pole
	WORK LOCATION
	UNDERGROUND VAULT - 1PH, 3PH
	UG TRANSFORMER - 1PH, 1PH PVT, Transclosure
	UG TRANSFORMER - 3PH
	KIOSK - 1PH, 3PH
	SECONDARY JUNCTION - Vault, Pedestal
	REMOVAL
	EASEMENT AREA - Dimensions ±10% (pending final survey)

LEGEND

Owner Name :	The Corporation of the City of Owen Sound
Owner Signature :	
Owner Name :	XX
Owner Signature :	
Prepared By :	Walmsley, Justin
PIN :	37050-0065
The location of the new or existing poles and anchors may not be exact. The stake marks the final location.	
schedule 'A' property easement sketch	

LETTER (8.5"x11")